



## **Self Cleaning Full Stainless Hidden Bottle Water Cooler with LED Indicators**

### **User Manual**

**Model No.: 8LIECH-SC-SSS-5L-W**

**PN: 5M011413XX00(E)-(650W)**

Users of mineral water please read descaling instructions on page 12.

**SAVE THIS MANUAL FOR FUTURE USE**

**Call toll-free: 1-855-594-4755 or send email to: [Whirlpool@electrotemp.com](mailto:Whirlpool@electrotemp.com)**

**IMPORTANT: Do NOT Return Dispenser to Store. If you have a question or problem, please call 1-855-594-4755 or [Whirlpool@electrotemp.com](mailto:Whirlpool@electrotemp.com) for assistance. Call center operates on EST time.**

---

Table of Contents

Safety Precautions ..... 1

Important Safety Instructions ..... 1

    Electrical Requirements..... 2

Product Features..... 2

SELF CLEANING - An Exclusive Feature..... 3

DESCALING HOT WATER TANK..... 3

KEY INFORMATION FOR FUTURE USE ..... 3

SPECIFICATIONS ..... 4

PARTS & FEATURES ..... 5

INSTALLATION AND INITIAL SETUP..... 6

    Location Requirements..... 6

    Initial Set Up ..... 6

CLEAN OUT OF THE BOX..... 8

OPERATION ..... 9

    Dispensing Cold Water ..... 10

    Dispensing Hot Water ..... 11

    Replacing an Empty Bottle ..... 11

    PROPER CARE & DESCALING ..... 12

        General Cleaning..... 12

        Descaling ..... 12

        Descaling Solutions ..... 12

        Descaling Procedure ..... 13



        LED INDICATOR LIGHTS ..... 13

FAQ-Frequently Asked Questions..... 14

Safety Precautions

Your safety and the safety of others are very important.

We have built many safety features into the cooler. We have also provided many important safety messages in this manual. Please read and follow the safety messages.

Meaning	Symbol
This is the safety alert symbol. This symbol alerts you to potential hazards that can hurt you or others.	
You can be seriously injured if you don't immediately follow the instructions.	
You can be seriously injured if you don't follow the instructions.	

All safety messages will follow the safety alert symbol and either the word “DANGER” or “WARNING”

All safety instructions will inform you what the potential hazard is, how to reduce the chance of injury, and what can happen if the instructions are not followed.

**State of California Proposition 65 Warnings:**

**WARNING:** This product contains one or more chemicals known to the State of California to cause cancer.

**WARNING:** This product contains one or more chemicals known to the State of California to cause birth defects or other reproductive harm.

The above warning applies to electrical components within this product only. Components within this product that contact drinking water do not contain the chemicals referred to in the above warning.

IMPORTANT SAFETY INSTRUCTIONS

**WARNING:** To reduce the risk of fire, electric shock, or injury when using your water cooler, follow these basic precautions:

- Plug it into a grounded 3-prong outlet.
- Do not remove the ground prong.
- Do not use an adapter.
- Disconnect the power before servicing.
- Never allow children to dispense hot water without proper and direct supervision. Unplug unit to prevent unsupervised use by children.

- Replace all the parts and the panels before operating.
- Do not use an extension cord.
- Two or more people should move and install the water cooler and the bottles.

## SAVE THESE INSTRUCTIONS

When operating this dispenser, please observe the following:

1. Prior to use, this dispenser must be properly assembled and installed in accordance to the instructions indicated in this manual.
2. This dispenser is intended only for water dispensing. Do NOT use other liquids, such as coffee, tea, juices, beer or wine. Do NOT use for other purposes. Never use liquids in the dispenser other than known and micro-biologically safe bottled water.

Electrical Requirements:

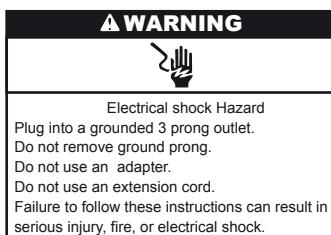

1. A 120 volt, 60 Hz., AC only, 15 amp, fused electrical supply is required. A time-delay fuse or circuit breaker is recommended. If codes permit and a separate ground wire is used, it is recommended that a qualified electrician determine that the ground path is adequate.
2. Check with a qualified electrician if you are not sure if the water cooler is properly grounded.
3. The proprietary design of the hot water tank assures availability of hot water and efficient energy use.

## **Product Features**

Congratulations! You have chosen a technologically advanced, state-of-the-art water cooler.

Your commercial grade water cooler is designed for heavy duty use while maintaining high performance and long life.

Superior components are rigorously tested before and during assembly to assure high quality of the product.

Clean, ready to use out of the box.

The cooler has an exclusive, dual self cleaning feature covering internal waterways and the water bottle.

Reliable and efficient self cleaning system was invented, patented and introduced by Electrotemp, and is proven by over 500 million coolers sold worldwide.

---

Offset, telescopic probe pumps out substantially all water, leaving less than one ounce of water in the bottle.

## SELF CLEANING - An Exclusive Feature

Your water cooler has an automatic dual SELF CLEANING feature to prevent the formation of bacteria laden Bio-film and to maintain the original quality of the bottled water. It is not meant to filter or purify dirty water.

International Bottled Water Association recommends manual cleaning of water cooler more often then three months apart. This machine will do it for you automatically every four hours. Carefully measured amounts of ozone are injected to kill harmful bacteria.

Ozone emission into ambient air is controlled in accordance with OSHA requirements. All waterways and the water bottle with probe are protected by the patented Automatic, Dual, Self Clean feature.

For more information on Bio-film in water coolers please see the below link which will take you to a study made by the Medical Faculty of the University of Laval, Quebec, Canada.

<http://aem.asm.org/content/60/4/1174.full.pdf>

## DESCALING HOT WATER TANK

Your cooler has a premium hot water tank with an integral bottom brazed heater element. It will not burn out from calcium build up and will last a lifetime.

Regular hot tanks with an internally mounted heater will burst from calcium build up.

To assure proper water flow, hot tank should be descaled periodically. It will require descaling only if mineral water is used. Frequency of descaling will depend on mineral content and could be done between 6 and 12 months. For detailed information on descaling please refer to see page 12 of this manual for detailed instructions.

## KEY INFORMATION FOR FUTURE USE

Please register your dispenser immediately at [www.vivaappliances.com/registration](http://www.vivaappliances.com/registration)

**TIP:** For future support, please record your serial number (located on the label at the back of the dispenser) and purchase date. Staple your receipt to the manual.

Item	Description
Product	Self-Cleaning Hidden Bottle Water Cooler
Model Number	8LIECH-SC-SSS-5L-W

Item	Description
Serial ID Number	(Located on the label at the back of the dispenser)
Date of Purchase	
Power Supply	AC 120V / 60Hz / 6.5Amp

**Three years of an Additional All inclusive Warranty (for the total of four years) is available for \$35. To buy, please call 1-855-594-4755 or email your request to [Whirlpool@electrotemp.com](mailto:Whirlpool@electrotemp.com).**

**SPECIFICATIONS**

Item	Description
Refrigerant Type	R-134A
Cold Water Power	<100 Watts
Cold Capacity / Hour	5 Liters / 1.32 Gallon/Hour
Cold Temperature	3°C-10°C / 37.4°F -50°F
Hot Water Power	650 Watts
Hot Capacity / Hour	6 Liters / 1.59 Gallon
Hot Temperature	80°C-92°C / 176°F -197.6°F
Dimensions	102.8cm H x 32cm W x 38.2cm D 40.5inch H x 12.6inch W x 15inch D
Net Weight	36.2 lbs / 16.4 Kg



**Version 2.0**  
**Energy**  
**Verified**

PARTS & FEATURES

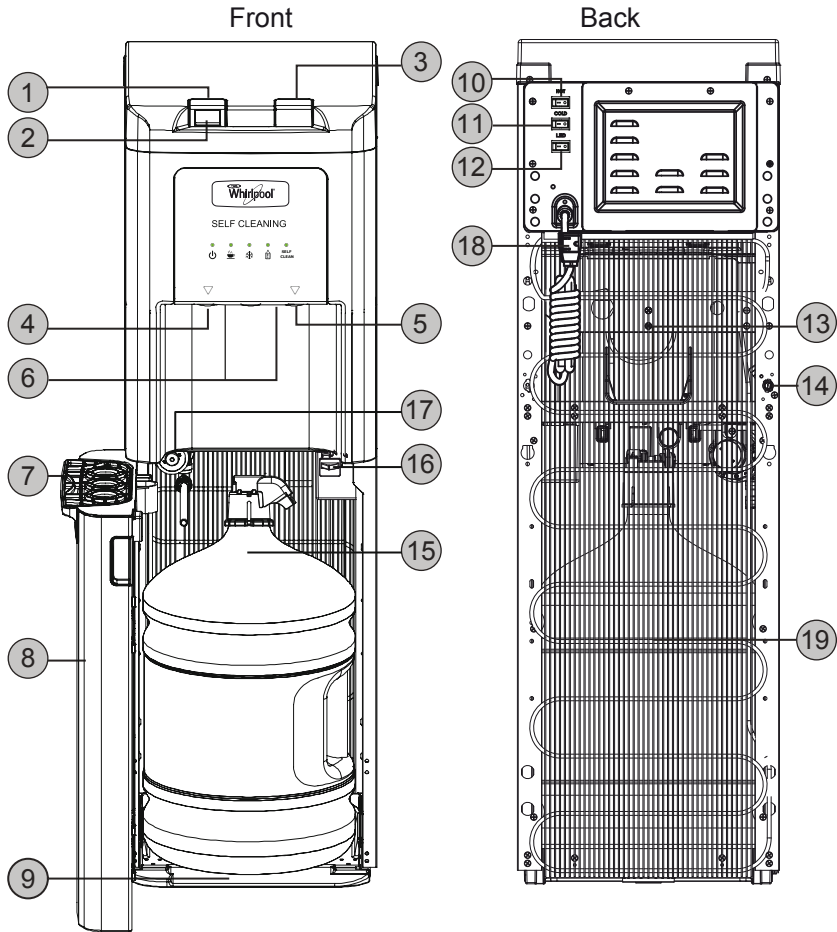

- |                                 |    |                                  |    |
|---------------------------------|----|----------------------------------|----|
| Hot Water Actuator              | 1  | Cold Power Switch(Energy Saving) | 11 |
| Toddler Safe Hot Water Lock     | 2  | Switch for LED Night Light       | 12 |
| Cold Water Actuator             | 3  | Carry Handle                     | 13 |
| Hot Water Faucet                | 4  | Drain Plug                       | 14 |
| Cold Water Faucet               | 5  | Bottle Probe                     | 15 |
| Low Energy LED Night lights     | 6  | Door Switch                      | 16 |
| Drip Tray                       | 7  | Water Pump                       | 17 |
| Door                            | 8  | Power Cord                       | 18 |
| Base Plate                      | 9  | Condenser                        | 19 |
| Hot Power Switch(Energy Saving) | 10 |                                  |    |

## INSTALLATION AND INITIAL SETUP

### **⚠ WARNING**

#### Electrical Shock Hazard

To prevent risk of electrical shock:

- Plug into a grounded 3-prong outlet.
- Do not remove ground prong.
- Do not use an adapter.
- Do not use an extension cord.
- Failure to follow these instructions can result in serious injury and fire due to electrical shock.

### **⚠ WARNING**

#### Excessive Weight Hazard

Use two or more people to move and install the water cooler and the bottles.

Failure to do so can result in back or other injury.

## Location Requirements

1. Install the unit in an area where it is protected from the elements, including direct sun.
2. DO NOT use locations with high humidity, close to sink, showers, etc. DO NOT install close to cooking appliances, avoid areas with cooking grease.
3. Keep away from detergents, acids or areas where spilling or evaporation of such substances may occur.
4. Install and use only on a hard, flat and level surface.
5. Do NOT place the dispenser inside an enclosed space or cabinet.
6. Position the dispenser no closer than four inches from the wall. Leave at least four inches of clearance on all sides to permit free airflow.
7. Service should only be performed by a certified technician. Please call 1-855-594-4755 for assistance.

**Note:** Do NOT plug in the power cord until you are instructed to do so.

---



## Initial Set Up

If you did not transport the water cooler laying on its side you can bypass instructions in (12).

**NOTE:** Do NOT plug in until steps 11-19 are completed.

8. If unit was transported on its side, then make sure unit is in the OFF position and is upright for at least four hours prior to plugging the unit in.
9. Level the water cooler as shown below to prevent vibration.

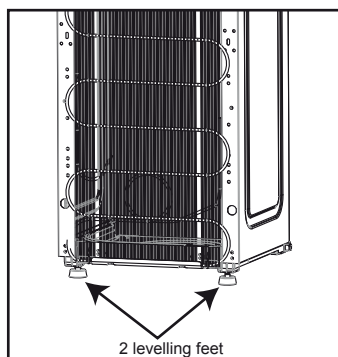

There are two leveling feet at the back of the water cooler.

Please adjust them one at a time until the water cooler sits levelly and does not rock.

Failure to level the water cooler can cause vibrational noise when the compressor runs.

10. This model uses a pump to deliver water from the bottle to the reservoirs.
11. Clean the bottle cap and neck.
12. Remove the entire plastic cap from bottle.
13. Adjust the length of the probe by pulling the B portion of the tube to its maximum extension. Insert the probe into the bottle and push it down. The probe will self-adjust to its appropriate A length. (See illustration).

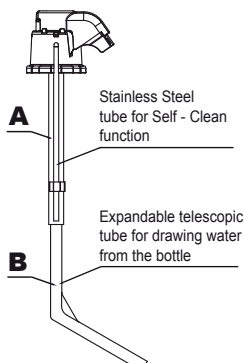

14. Push down the probe head until it is seated.
15. Push bottle into compartment and close the door. Ensure the plastic tubing is not interfering with the door.
16. Plug power cord into the wall outlet.

**NOTE:** At initial set up it will take less than three minutes to fill reservoirs with water. If the pump stops prematurely, please open and close the door to activate the door switch reset.

## **CLEAN OUT OF THE BOX, NO NEED FOR CLEANING PRIOR TO INITIAL USE**

Your water cooler is Clean Out of The Box. Cleaning described below is not required. However if you choose to clean your water cooler for any reason, please follow the instructions below.

Time Required: 45 minutes.

Notice: Unplug the power cord.

1. Remove the air filter and wash it in soapy water.
  2. Submerge the probe head in the soapy water and rinse properly.
  3. Spray the dispensing nozzles of water faucets with chlorine solution (one teaspoon of unscented bleach composition (I.E. 5.25% sodium hypochlorite) in one glass of water).
  4. Reattach air filter of the probe assembly.
  5. Fill bottle with chlorine solution ( 60 ml of unscented bleach) per 3 liters of water) and activate the pump. Allow chlorine solution to wash probe inside. Shut off after 3 liters of solution is pumped through.
  6. Place a 2 gallon or larger bucket under the drain plug in the rear of the cooler.
  7. Once the unit has been drained, replace the drain plug and drain cap.
  8. Remove the remaining water from the reservoirs by dispensing it from the cold tap into a pitcher.
-

## Rinsing

9. Fill bottle with 2 gallons of tap water.
10. Insert probe assembly, place bottle into water cooler and close the door.
11. Allow cooler to be filled with water.
12. Drain water out as in steps 10, 11 and 12.
13. If chlorine taste persists repeat rinsing procedure or leave it sit for a few days and chlorine taste will disappear.
14. Use a 10% vinegar solution instead of chlorine solution.
15. Complete the installation and follow the operation instructions indicated in this manual.  
If your water has an off taste do not return the cooler to the store, call 1-855-594-4755 for assistance.

## OPERATION

**IMPORTANT:** The unit's self cleaning feature prevents the formation of Biofilm. The self cleaning feature is not intended for water purification.

This unit is intended for use with high-quality bacteriologically safe bottled water only. Do NOT use other liquids, including but not limited to tap water, coffee, tea, juices, beer, or wine. Do NOT use for other purposes.

This dispenser has been designed for use with standard water bottles with a 3, 5, or 5.2 gallon capacity. Do NOT use alternative bottles.

**NOTICE:** ROUND bottles can be easily loaded. They have no "sides". Rectangular bottles will go in one way only. Long side must be loaded front to back. Please see instructions below on how to load rectangular bottles.

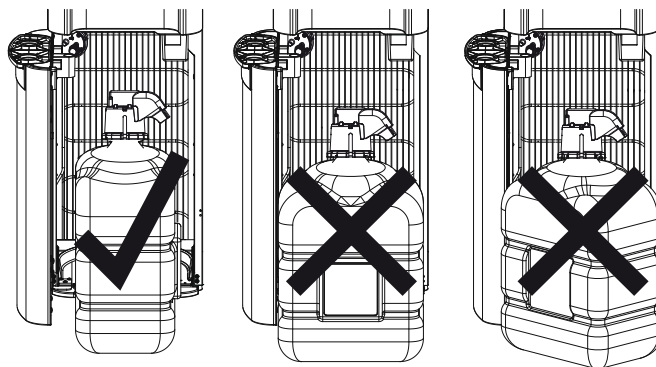

Turn the switches at the back of the dispenser to ON.

- The red switch controls the hot water. If you do not want hot water, leave this switched OFF.
- The blue switch controls the cold water. If you do not want cold water, leave this switched OFF.
- The yellow switch controls the LED night lights. Turn it ON or OFF as desired.

**NOTE:** For the unit to operate properly, the probe head must sit on the bottle and the door must be closed.

**NOTE:** It will take a few minutes to fill the reservoirs with water. During this time, the pump may turn on and off, this is normal.

**NOTE:** Each time you dispense water from the taps, the pump will turn on to refill the tanks. This is normal.

**NOTE:** Self cleaning works every four hours for a short time. The self cleaning pump sound is normal.

## Dispensing Cold Water

**NOTE:** After setup, it will take over one hour to get the water to its coldest temperature. During this time, the compressor may run continuously as the refrigeration system builds the "Ice Bank"; this is normal.

1. Position the container you are wishing to fill with water, securely below the cold water tap.
    - The right triangle below the cold water control indicates the location of the cold water tap (See the **PARTS & FEATURES** section).
    - The circular shapes in the drip plate help align the flow of water. This unit dispenses water at a fast rate. To avoid splashes, hold the cup as close to the tap as possible.
  2. Press the right control downward to start dispensing water.
  3. Release the control once desired fill level is achieved.
-

## Dispensing Hot Water

**NOTE:** After setup, hot water will be available in 15-20 minutes.

1. Position the container you are wishing to fill with water, securely below the hot water tap.
  - The left triangle below the hot water control indicates the location of the hot water tap (See the **PARTS & FEATURES** section).
  - The circular shapes in the drip plate help align the flow of water. To avoid splashes, hold the cup as close to the tap as possible.
2. Push the hot water release button (red) inward and press the control downward to start dispensing water.
3. Release the control once desired fill level is achieved.

## Replacing an Empty Bottle

### **WARNING**

Excessive Weight Hazard  
Use two or more people to move and install bottles.  
Failure to do so can result in back or other injury.

**Note:** When your water bottle is empty, the EMPTY BOTTLE lights will blink until a fresh bottle is installed. You may also hear a sucking sound when the bottle is empty and needs changing. This is normal and is another way to be alerted that your bottle is empty and needs to be replaced.

Replace the bottle as soon as you notice that it is empty.

There may be a small amount of water left in the bottle. Adjust length of telescopic probe to allow offset portion to pump water from the lowest point in the bottle. Usually it is a rounded corner. You should have less than 1 ounce of water left under normal operation.

To remove an empty bottle:

- Open the door and slide the bottle out.

To install fresh bottle:

- Place the fresh bottle in front of the tray.
  - Clean the fresh bottle using a soft cloth and warm soapy water.
  - Remove the entire plastic cap from the top of the bottle.
  - Remove probe from old bottle and insert into the fresh bottle.
-

- Push the probe down until it is seated.
- Slide the bottle onto the tray and close the door completely.

## PROPER CARE & DESCALING

### General Cleaning

**Perform:** As needed

**Time Required:** Fifteen minutes.

**NOTE:** Do NOT use abrasive materials or chemical cleaners.

1. Clean cabinet surfaces with a soft cloth and warm soapy water.
2. Wipe dust from back of dispenser to improve the unit's efficiency.
3. Remove the drip tray assembly by sliding it forward. Remove the cover. Wash both tray and cover in a dishwasher or wipe parts clean with a soft cloth and warm soapy water.
4. Use paper towel to wipe dry.
5. Evenly rub small amount of stainless steel cleaning oil, or unscented baby oil. Wipe nearly dry using paper towel.
6. Reattach drip tray assembly.

### Descaling

If you use mineral water you will need to de-scale your hot water tank.

Heated mineral water will cause minerals to fall out. Eventually they will plug up your waterways, resulting in a gradual slowdown of the flow rate, leaking faucets, and other problems.

### Descaling Solutions

Cooking vinegar is proven to remove calcium deposits efficiently.

Depending on the frequency of decalcification treatments, please use the following proportions of White Vinegar.

- For descaling once every three months, use two cups (500 ml) of white vinegar with 2.5 liters of hot water.
  - For descaling once every six months, use a mixture of six cups (1500 ml) of white vinegar with two liters of hot water.
  - For descaling once every year, use 12 cups (3000 ml) of white vinegar and one liter of hot water.
-

- For descaling less frequently than once a year, use undiluted white vinegar.

### **Descaling Procedure**

1. Fill a bucket or empty 5-gallon water bottle with solution of white vinegar. For proportions, refer to the instructions above. Choose quantity in accordance with the frequency of your treatments.
2. Attach or insert the probe to the bucket/bottle.
3. Place the bucket/bottle into the cooler and close the door. The water will be pumped up into the holding tanks.
4. Plug in the cooler and turn on the hot switch located at the back of the cooler. Do not turn on the cold-water switch.
5. Wait for 1 hour.
6. Unplug the cooler from the wall
7. Using rear drain plug, drain the water from the cooler into a bucket and discard the water.
  - a. Locate the white plastic cap at the back of the cooler.
  - b. Remove the screw.
  - c. Remove the clear silicone drain plug and allow water to drain out.
  - d. Re-attach the drain plug and plastic cap before proceeding.
  - e. Fill the bucket/bottle with tap water and place into the machine.
8. Plug the cooler back into the wall, close the door and wait for 10 minutes.
9. Dispense water from both cold and hot faucets until smell from cleaning substances disappears.
10. Open drain plug and cap once again and drain all tap water.
11. Replace the drain plug and cap.
12. Place a fresh bottle of water into the machine and operate as usual.
13. This procedure must be repeated every 3 to 6 months, depending on mineral content and usage of water cooler.

### **LED INDICATOR LIGHTS**

#### **POWER INDICATOR (1)**

When the LED light is constantly lit it indicates that power is being supplied to the unit.

#### **HEATER INDICATOR (2)**

---

When the LED light is flashing it indicates that the heating system is working. When the LED light is constantly lit, it indicates that the hot water is ready. When the LED light is off it shows that the heating system is off.

### COOLING INDICATOR (3)

When the LED light is flashing it indicates that the cooling system is working. When the LED light is constantly lit, it indicates that the cold water is ready. When the LED light is off it indicates that the cooling system is off.

### EMPTY BOTTLE INDICATOR (4)

The LED light is constantly lit when the water bottle has enough water for normal operation. When the LED light is flashing it indicates that the level of water in the bottle is low and a new full bottle should be installed.

### SELF CLEAN INDICATOR (5)

When the LED light is flashing it indicates that the self cleaning takes place. When the LED light is constantly lit it indicates that the self clean protection is on.

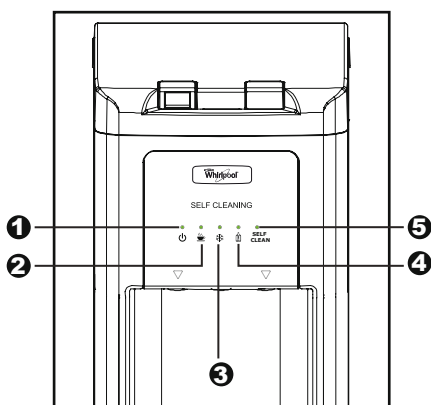

## FAQ-Frequently Asked Questions

**Q1.** Does the night light in the front of the cooler stay on?

There is a switch at the top back of the water cooler to turn the LED lights on or off.

**Q2.** Do the LED lights use a lot of electricity?

No. LED lights are known for being energy efficient and consume very little energy.



**Q3.** I can't find the rectangular bottles? What other kind of bottles does the cooler take?

The cooler will accept any standard three or a five gallon water bottle, circular or rectangular.

**Q4.** How do I know when and if the Self Cleaning function is working?

The self cleaning function will run every four hours and the self clean LED light will flash. Between self clean cycles, the LED light is glowing steady to indicate that cooler is protected from contamination.

**Q5.** Can I use anything else other than bleach for cleaning the water cooler?

Bleach is safe to use to clean the machine. However, if you wish you can use a vinegar based solution instead. Mix 16 oz of vinegar per every gallon of water.

**Q6.** How important is the cleaning procedure?

The cooler is ready to use and cleaning it right out of the box is not required. See cleaning instructions.

**Q7.** Where is the drain plug located?

The drain plug is located on the back right hand side of the cooler. A white plastic cover is situated over the white silicone plug. A Phillips screwdriver must be used to remove the plug.

**Q8.** There is no hot or cold water?

Ensure that both the hot and cold buttons on the back side of the cooler have been turned on. The LED lights on the control panel will have a steady glow indicating the power has been turned on. When lights are flashing, heating and cooling is currently taking place.

**Q9.** Which side is on and which side is off?

The "0" is OFF and the "-" sign is ON . ON/OFF status can be seen by looking at LED on the front panel.

**Q10.** The water is not pumping water into the holding tank.

Ensure that the front door of the cooler is closed. In the event the cooler door is not closed the pump will not be activated. If pump is still not being activated reset the power.

---

**Q11.** Can the cooler be used without plugging it in?

No, the cooler must be connected to power for it to work properly.

**Q12.** How long is the warranty?

The cooler comes with a limited one year warranty. An extended warranty is available for an additional cost. For extended warranty information please call 1-855-594-4755 or email your request to [Whirlpool@electrotemp.com](mailto:Whirlpool@electrotemp.com).

**Q13.** Do the lights at the back for the hot and cold water illuminate?

No, they do not.

**Q14.** Where is the filter for the air intake?

The filter is located on the top of the probe. The filter resembles a black sponge.

**Q15.** Does the air filter need to be washed or changed?

No, the filter does not need to be washed or changed. If you desire, the filter can be cleaned by unscrewing the cover on top of bottle cap the filter can then be removed for washing.

**Q16.** The warrant has expired and the cooler is out of warranty.

Please call 1-855-594-4755 or email your request to [Whirlpool@electrotemp.com](mailto:Whirlpool@electrotemp.com).

**Q17.** Hot water tap is dripping.

Perform de-scaling procedure outlined in cleaning section.

**Q18.** Room lights are flickering when the water cooler is plugged in and turned on.

Ensure you are using an approved 15 amp outlet.

**Q19.** Stainless steel surfaces are smudgy or fingerprinted.

- Use paper towel to wipe off excess oils until surface feels dry to the touch.
  - To maintain beauty of stainless steel, use any approved stainless steel cleaner.
-

**Q20.** The buttons for dispensing water are slow-moving or jammed.

Ensure that buttons are clean and no dust or particles are causing buttons to move slowly.

**Q21.** Dispenser is not operating.

Make sure that the power cord is properly connected to a working outlet.

**Q22.** Water is leaking.

Replace water bottle. The most common cause of this issue is a cracked bottle. If the leak remains, unplug unit and call 1-855-594-4755 for assistance (Bottles do crack. Water companies replace polycarbonate bottles after 30 cycles of use.).

**Q23.** No water is coming from the taps.

- Make sure the water bottle is not empty. If it is, replace it. If not, adjust the probe to an appropriate length.
- Make sure that the controls have been fully activated.
- Make sure that the probe connection with the water bottle forms a complete seal.
- Make sure that the door is closed.

**Q24.** Water dispensed is not cold.

- Please note that it takes a minimum of one hour after setup to dispense cold water.
- Make sure that the back of the dispenser is at least 4 inches from a wall and that air is free to flow on all 4 sides of the dispenser.
- Make sure that the cold-water switch is ON.

**Q25.** Water dispensed is not hot.

- Please note that it takes approximately fifteen to twenty minutes after setup to dispense hot water.
- Make sure that the power cord is properly connected to a working outlet.
- Make sure that the hot-water switch is ON.

**Q26.** Empty bottle LED light is flashing.

Replace the empty bottle. If you cannot replace the empty bottle immediately, leave the door ajar or unplug the cooler to stop the flashing lights.

---

**Q27.** The dispenser is noisy.

Make sure the cooler is properly levelled using the two adjustable feet at the back of the unit.

**Q28.** Water tastes bad.

- Drain the water from the reservoirs and replace the bottle with a fresh one.
- Clean cooler as outlined in the **PROPER CARE & DESCALING** section.

**Q29.** Pump is not pumping water into cooler.

Make sure that tubing is properly inserted into quick connectors on the pump.

For other questions call 1-855-594-4755 for assistance or send E-mail to [Whirlpool@electrotemp.com](mailto:Whirlpool@electrotemp.com).

This device complies with Part 15 of the FCC Rules. Operation is subject to the following two conditions: (1) This device may not cause harmful interference, and (2) this device must accept any interference received, including interference that may cause undesired operation.

**LIMITED WARRANTY**

Electrotemp Technologies Inc., ("Vendor") warrants to the original purchaser of this dispenser, and to no other person, that if this dispenser is assembled and operated in accordance with the printed instructions accompanying it, then for a period of one (1) year from the date of purchase, all parts in such dispenser shall be free from defects in material and workmanship. Vendor may require reasonable proof of your date of purchase from an authorized retailer or distributor. Therefore, you should retain your sales slip or invoice. The Limited Warranty shall be limited to repair or replacement of parts, which prove defective under normal use and service and which Vendor shall determine in its reasonable discretion upon examination to be defective. Before returning any parts, you should contact Vendor's Customer Service Department using the contact information listed below. If Vendor confirms, after examination, a defect covered by this Limited Warranty in any returned part, and if Vendor approves claim, Vendor will replace such defective part without charge. If you return defective parts, transportation charges must be prepaid by you. Vendor will return replacement parts to original purchaser, freight or postage prepaid.

The Limited Warranty does not cover any failures or operating difficulties due to accident, abuse, misuse, alteration, misapplication, improper installation or improper maintenance or service by you or any third party, or failure to perform normal and routine maintenance on the dispenser, as set out in the User's Manual. In addition, the Limited Warranty does not cover damages to the finish, such as scratches, dents, discoloration or rust after purchase.

---

The Limited Warranty is in lieu of all other express warranties. Vendor disclaims all warranties for products that are purchased from seller other than authorized retailers or distributors. AFTER THE PERIOD OF THE ONE(1) YEAR EXPRESS WARRANTY, VENDOR DISCLAIMS ANY AND ALL IMPLIED WARRANTIES, INCLUDING WITHOUT LIMITATION THE IMPLIED WARRANTIES OF MERCHANTABILITY AND FITNESS FOR A PARTICULAR PURPOSE. FURTHER, VENDOR SHALL HAVE NO LIABILITY WHATSOEVER TO PURCHASER OR ANY THIRD PARTY FOR ANY SPECIAL, INDIRECT, PUNITIVE, INCIDENTAL, OR CONSEQUENTIAL DAMAGES. Vendor assumes no responsibility for any defects caused by third parties. This Limited Warranty gives the purchaser specific legal rights; a purchaser may have other rights depending upon where he or she lives. Some jurisdictions do not allow exclusion or limitation of special, incidental or consequential damages, or limitations on how long a warranty lasts, so the above exclusion and limitations may not apply to you.

Warranty is void if the electrical outlet is improperly wired to incorrectly sized circuit breaker or fuse, if not grounded properly, or wires do not have correct polarity.

Use of this cooler confirms Purchasers agreement with the conditions of this warranty.

Electrotemp Technologies Inc.

406 Watline Avenue Mississauga, Ontario, L4Z-1X2

1-855-594-4755

[www.electrotemp.com](http://www.electrotemp.com)

Limited warranty provided by manufacturer.

®/™ ©2016 Whirlpool. All rights reserved.

Manufactured under license by Electrotemp Technologies Inc., Mississauga, ON. Canada

Limited warranty provided by manufacturer.

---